

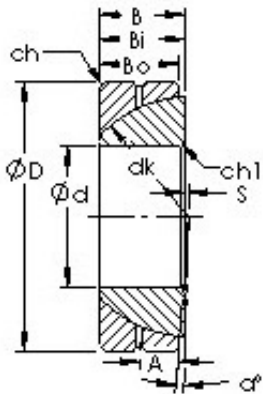

# BEARING CORP. LTD.



GAC50S Bearing 2D drawings and 3D CAD models

## AST GAC50S plain bearings

Bearing No. GAC50S

Size	50x80x20 mm
Bore Diameter	50 mm
Outer Diameter	80 mm
Width	20 mm
Bearing Type - steel-on-steel	steelonsteel
Bore Dia (d)	50.0000
Outer Dia (D)	80.0000
Width (B)	20.0000
Outer Width (Bo)	19.0000
Inner Width (Bi)	20.0000
Dynamic Load Rating (Cr)	123,000
Static Load Rating (Cor)	618,000
Max. shaft corner radius, or 45 deg. chamfer (ch1)	1.000
Max. housing corner radius, or 45 deg. chamfer (ch)	1.000
Spherical Diameter (dk or Dk)	74.000
Mis-alignment Angle (a deg.)	1.5
Lubrication Groove Location (A)	10.000
Spherical Center Location (S)	4
Weight (g)	455.00
Material	52100 Chrome steel, or equivalent