

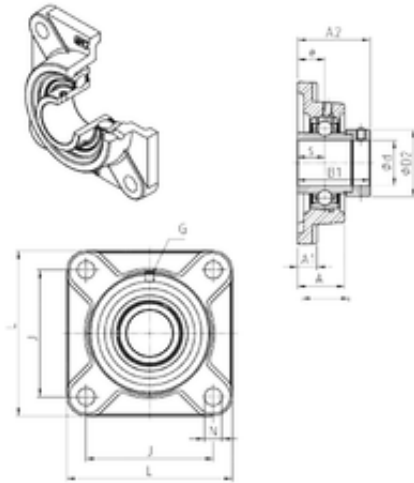

# BEARING CORP. LTD.

## SNR EXF319 bearing units

Bearing No. EXF319



EXF319 Bearing 2D drawings and 3D CAD models

Bore Diameter	95 mm
d	95 mm
e	59 mm
s	46,8 mm
A	94 mm
A1	30 mm
B1	122,3 mm
D2	140 mm
J	228 mm
L	290 mm
N	35 mm
Thread (G)	M10x1
A2	134,5 mm
Weight	22,8 Kg
Basic dynamic load rating (C)	156 kN
B	93.7 mm
d1	140 mm
G	M10x1
s1	83.35 mm
S	46.8 mm
C	156 kN
C0	122 kN
T min.	-20 ° C
T max.	100 ° C
Recommended tightening torque for set screw	120 Nm



## BEARING CORP. LTD.

Designation of housing	F319-
Designation of bearing	EX319G2